

CLERK'S OFFICE
APPROVED
Date: 12-16-03

Submitted by: Chairman of the Assembly
at the request of the
School Board
Prepared by: Anchorage School District
For Reading: December 16, 2003

ANCHORAGE, ALASKA
AR NO. 2003-350

A RESOLUTION OF THE ANCHORAGE MUNICIPAL ASSEMBLY APPROVING
THE REVISED (SCHEMATIC) DESIGN OF THE SAND LAKE ELEMENTARY
SCHOOL ADDITION AND RENOVATION PROJECT

WHEREAS, Alaska Statute 14.14.060(e) provides that the Assembly approve the revised design approved by the School Board for design of school facilities, and

WHEREAS, the School Board has approved the revised (schematic) design for Sand Lake Elementary School Addition and Renovation Project.

NOW, THEREFORE, the Anchorage Assembly resolves:

Section 1. The Assembly hereby approves the revised design for Sand Lake Elementary School Addition and Renovation Project.

Section 2. This resolution shall become effective immediately upon its passage and approval by the Anchorage Assembly.

PASSED AND APPROVED by the Anchorage Assembly this 16th day of
December, 2003

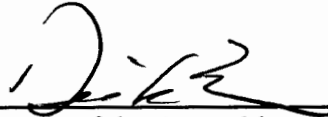
Chair of the Assembly

ATTEST

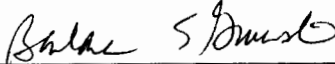
Municipal Clerk

ANCHORAGE SCHOOL DISTRICT
ANCHORAGE, ALASKA

AM 867-2003

MEMORANDUM

December 16, 2003

TO: THE HONORABLE MARK BEGICH
ANCHORAGE ASSEMBLY

FROM: OFFICE OF THE SUPERINTENDENT

Carol Comeau

SUBJECT: APPROVAL OF THE REVISED (SCHEMATIC) DESIGN FOR THE
SAND LAKE ELEMENTARY SCHOOL ADDITION AND
RENOVATION PROJECT

In accordance with AO NO. 2000-106(S), this memorandum provides information required for submission and approval of the revised design for Sand Lake Elementary School Addition and Renovation Project. The revised design consists of a schematic design to increase Sand Lake Elementary School from a 24-classroom to a 26-classroom elementary school. The Schematic Design was approved by the School Board on November 24, 2003, ASD Memorandum # 124 (2003-2004).

The School Board approved the selection of Krochina Architects to be the Architects of Record on October 14, 2002, ASD Memorandum #76 (2002-2003) and the Municipal assembly approved the selection on October 15, 2002 (AR #2002-308). The preliminary (conceptual) design was approved by the School Board on May 12, 2003, ASD Memorandum #263 (2002-2003) and by the Municipal Assembly on May 20, 2003 (AR 2003-109).

AO NO. 2000-106(S) requires a description of the proposed school site; school building and building program; the projected student population; the total construction budget and the funding source; the projected project schedule; and any known neighborhood impacts, comments, reactions, which reflect potential impacts of the school building on the neighboring community. These responses follow:

Sand Lake Elementary School is located in Southwest Anchorage at 7500 Jewel Lake Road. It occupies a 10-acre site with residential housing and a church on the north and south sides respectively, municipal park land on the west side with vehicular access only from Jewel Lake Road on the east side. The school was built in 1958 with additions in 1964 and 1987.

Sand Lake Elementary School provides both traditional and Japanese Immersion programs for kindergarten through 6th grade. The October 31, 2003 enrollment is 635 students, equaling 131 percent of current capacity. Projections through 2008-2009 continue to indicate over current capacity of at least 128 percent. The Revised Design is based on the Districtwide Elementary Educational Specifications for a 26-Classroom Elementary School adopted by the School Board November 2000. With the addition of approximately 4,800 square feet, the building will increase to 60,995 gross square feet and will serve the standard elementary schools capacity of 550 students.

49 On April 1, 2003 voters approved \$750,000 to fund the design of additions and
50 renovation for Sand Lake Elementary School. Subject to obtaining construction funding
51 in April 2004, construction is scheduled to start in 2005. The project's currently
52 estimated construction cost is \$7,300,000.

53
54 All Building Design Committee meetings were attended by members of ASD Facilities
55 Department and members of the Sand Lake Elementary School administration, staff,
56 teachers, and parents. Sand Lake Community Council was invited to participate. A major
57 concern for staff and parents, beyond the current overcrowding, is the ongoing
58 automobile traffic due to parent transportation for the Japanese Immersion program and
59 neighborhood students. Site access is difficult, especially during morning drop-off, with
60 traffic backing up in both directions onto Jewel Lake Road. The proposed design
61 improves the existing situation as much as possible by increasing on-site queuing space.
62 As a further improvement, the Municipality of Anchorage has indicated it will provide a
63 traffic signalization device with the upcoming Strawberry Road Improvements project.
64 Another community concern was that the existing hockey rink be retained. All concerns
65 brought up at these meetings have been addressed in the design, and there are no
66 anticipated negative impacts on the school building or neighboring community.

67
68 Attached is a set of Revised (Schematic) design drawings.

69
70 AR 2003-350

71
72 Attachment
73

44. AZ 2003-352



PROPOSED SITE PLAN
SCALE
1" = 40'-0"

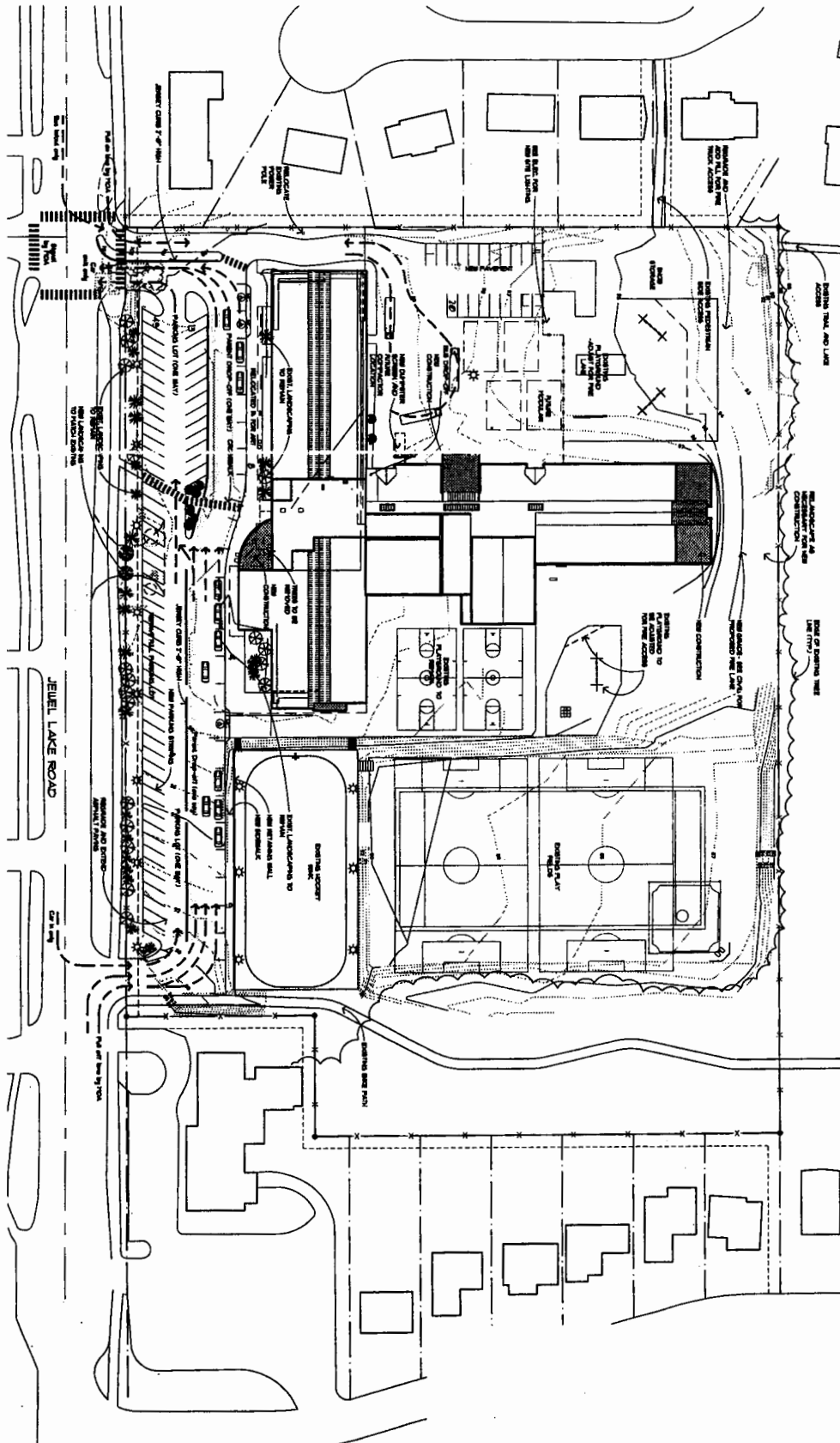

Project: SAND LAKE ELEMENTARY	Client: SAND LAKE ELEMENTARY
Design: 2015.11.17	Drawn: 2015.11.17
Check: 2015.11.17	Scale: 1" = 40'-0"
Job No: 2204	Date: Oct 17, 2003
Draw Title: PROPOSED SITE PLAN	Sheet: A11

Sand Lake Elementary
Addition and Renovation
7800 Jewel Lake Road
Anchorage, AK 99502

KROCHINA ARCHITECTS AIA
3501 Denali Street, Suite 303, Anchorage, Alaska 99503
907.651.2241 www.krochina.com



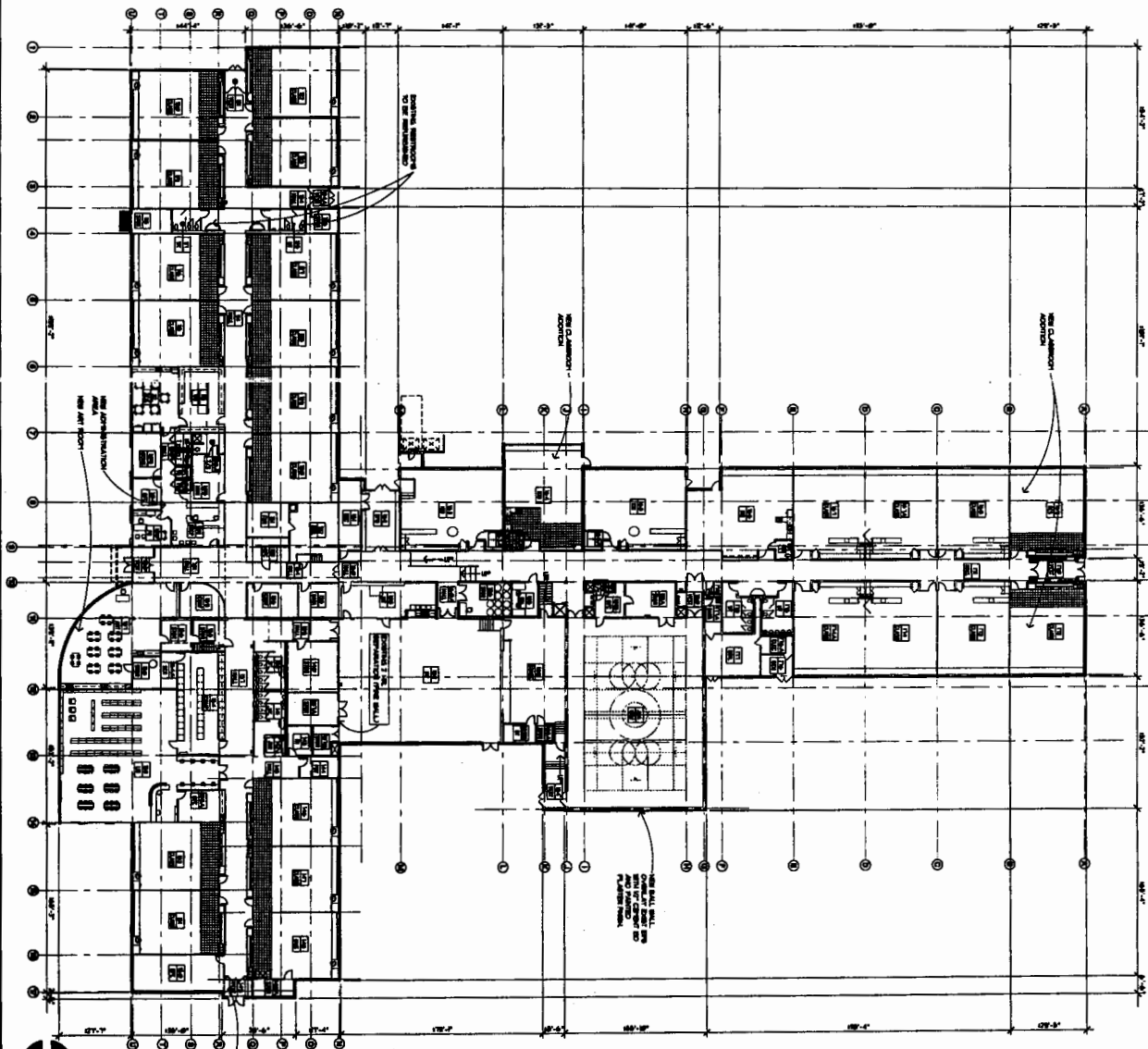

OVERALL FLOOR PLAN
 SCALE
 1"=20'-0"

- LEGEND:**
- 1" TH. BRICK & 1" OC
 - 4" TH. BRICK & 1" OC
 - 6" TH. BRICK & 1" OC
 - 8" TH. BRICK & 1" OC
 - 10" TH. BRICK & 1" OC
 - 12" TH. BRICK & 1" OC
 - 14" TH. BRICK & 1" OC
 - 16" TH. BRICK & 1" OC
 - 18" TH. BRICK & 1" OC
 - 20" TH. BRICK & 1" OC
 - 22" TH. BRICK & 1" OC
 - 24" TH. BRICK & 1" OC
 - 26" TH. BRICK & 1" OC
 - 28" TH. BRICK & 1" OC
 - 30" TH. BRICK & 1" OC
 - 32" TH. BRICK & 1" OC
 - 34" TH. BRICK & 1" OC
 - 36" TH. BRICK & 1" OC
 - 38" TH. BRICK & 1" OC
 - 40" TH. BRICK & 1" OC
 - 42" TH. BRICK & 1" OC
 - 44" TH. BRICK & 1" OC
 - 46" TH. BRICK & 1" OC
 - 48" TH. BRICK & 1" OC
 - 50" TH. BRICK & 1" OC
 - 52" TH. BRICK & 1" OC
 - 54" TH. BRICK & 1" OC
 - 56" TH. BRICK & 1" OC
 - 58" TH. BRICK & 1" OC
 - 60" TH. BRICK & 1" OC
 - 62" TH. BRICK & 1" OC
 - 64" TH. BRICK & 1" OC
 - 66" TH. BRICK & 1" OC
 - 68" TH. BRICK & 1" OC
 - 70" TH. BRICK & 1" OC
 - 72" TH. BRICK & 1" OC
 - 74" TH. BRICK & 1" OC
 - 76" TH. BRICK & 1" OC
 - 78" TH. BRICK & 1" OC
 - 80" TH. BRICK & 1" OC
 - 82" TH. BRICK & 1" OC
 - 84" TH. BRICK & 1" OC
 - 86" TH. BRICK & 1" OC
 - 88" TH. BRICK & 1" OC
 - 90" TH. BRICK & 1" OC
 - 92" TH. BRICK & 1" OC
 - 94" TH. BRICK & 1" OC
 - 96" TH. BRICK & 1" OC
 - 98" TH. BRICK & 1" OC
 - 100" TH. BRICK & 1" OC

A21

Doc: 02/24/21
 Title: OVERALL FLOOR PLAN
 Date: Oct 17, 2023
 Job No: 0224

Drawn: LMO/JS
 Checked: DJH
 Reviewed:

Sand Lake Elementary
 Addition and Renovation
 7500 Jewel Lake Road
 Anchorage, AK 99502

KROCHINA ARCHITECTS AIA
 3501 Denali Street, Suite 303, Anchorage, Alaska 99503
 (907) 551-2241 www.krochina.com



4 NORTH ELEVATION
SCALE 1/16" = 1'-0"

3 WEST ELEVATION

SCALE 1/8" = 1'-0"

2 SOUTH ELEVATION
SCALE 1/8" = 1'-0"

1 EAST ELEVATION
SCALE 1/8"=1'-0"



Municipality of Anchorage
MUNICIPAL CLERK'S OFFICE
Agenda Document Control Sheet

AN2003-350

(SEE REVERSE SIDE FOR FURTHER INFORMATION)

1	SUBJECT OF AGENDA DOCUMENT Approval of the Revised (Schematic) Design for the Sand Lake Elementary School Addition and Renovation Project	DATE PREPARED 11/17/03
		Indicate Documents Attached <input type="checkbox"/> AO <input checked="" type="checkbox"/> AR <input checked="" type="checkbox"/> AM <input type="checkbox"/> AIM
2	DEPARTMENT NAME ASD FACILITIES DEPT.	DIRECTOR'S NAME RAY AMSDEN
3	THE PERSON THE DOCUMENT WAS ACTUALLY PREPARED BY RAY AMSDEN	HIS/HER PHONE NUMBER 348-5156
4	COORDINATED WITH AND REVIEWED BY	INITIALS DATE
	Mayor	
	Municipal Clerk	
	Municipal Attorney	
	Employee Relations	
	Municipal Manager	
	Cultural & Recreational Services	
	Fire	
	Health & Human Services	
	Merrill Field Airport	
	Municipal Light & Power	
	Office of Management and Budget	
	Police	
	Port of Anchorage	
	Public Works	
	Solid Waste Services	
	Transit	
	Water & Wastewater Utility	
	Executive Manager	
	Community Planning & Development	
	Finance, Chief Fiscal Officer	
	Heritage Land Bank	
	Management Information Services	
	Property & Facility Management	
	Purchasing	
	Other	
	Carol Comeau, Superintendent, ASD	<i>Carol S. Comeau 11/17/03</i>
	George Vakalis, Asst. Superintendent, Support Services	<i>George Vakalis 11/21/03</i>
5	Special Instructions/Comments	
	<i>Asst. Clerk</i>	
6	ASSEMBLY HEARING DATE REQUESTED 12/16/03	7
		PUBLIC HEARING DATE REQUESTED 12/16/03